

REVISIONS			
REV	DATE	ECO	APP'D

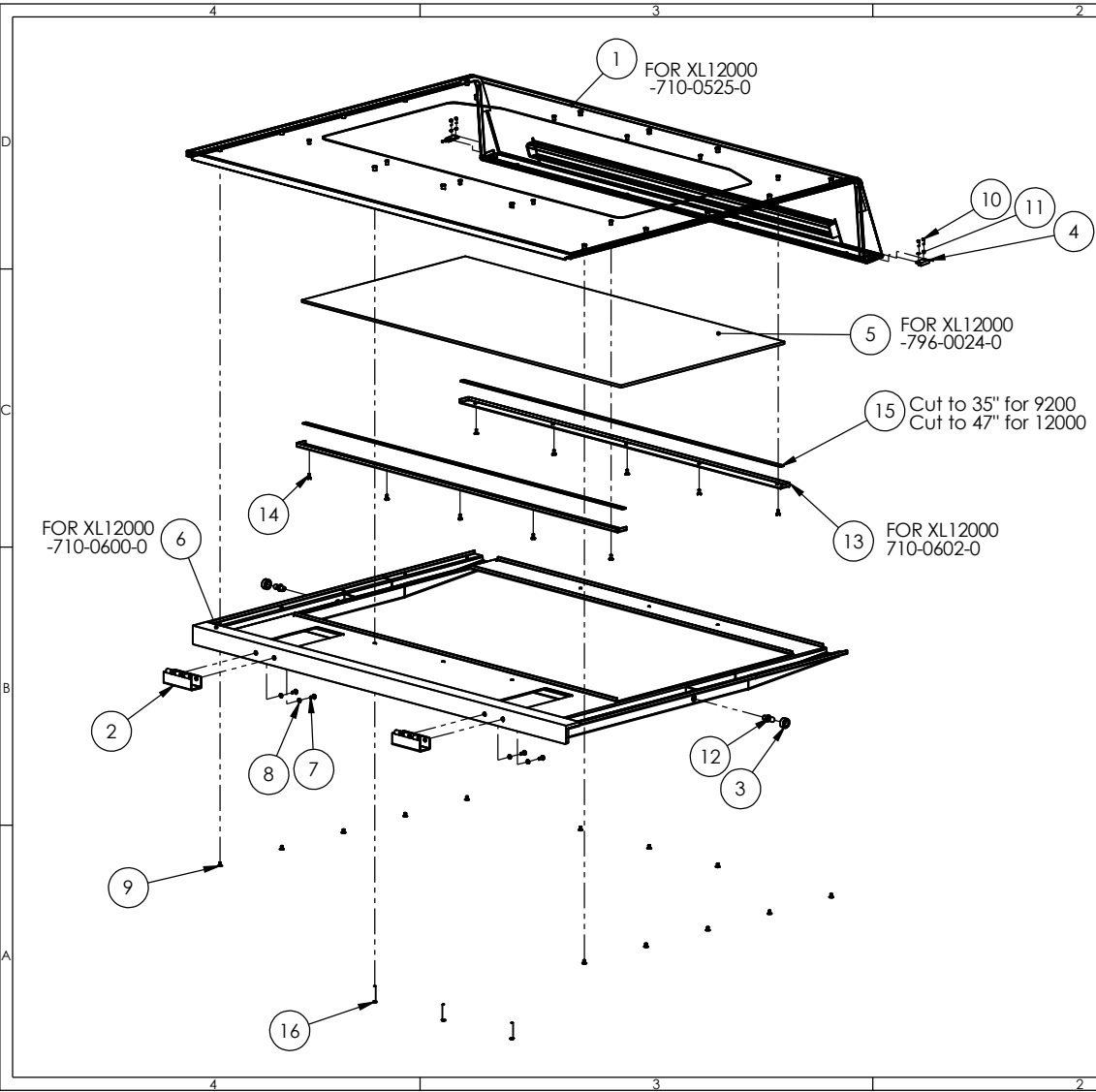

ITEM NO.	QTY.	PART	DESCRIPTION
1	1	710-0524-0	XL9200 TOP DOOR CAP
2	2	710-0544-0	XL TOP HINGE
3	2	795-0022-0	SHOCK SPACER
4	2	377-0002-0	Proximity Sensor Actuator
5	1	796-0023-0	XL9200 WINDOW
6	1	710-0599-0	XL9200 TOP DOOR SUPPORT
7	4	501-8006-0	BSCS 8-32 x .375 BLK
8	4	550-8100-0	LOCK WASHER #8
9	13	535-8004-0	FPCS 8-32 x .250 SS
10	4	500-4205-0	SCS 4-40 x .312 SS
11	4	550-4100-0	LOCK WASHER #4
12	2	700-0908-0	SHOCK MOUNT
13	2	710-0601-0	XL-9200 GLASS MOUNT
14	10	535-6005-0	FPCS 6-32 x .312 SS
15	2	820-0000-0	1/16 x 3/8 FOAM TAPE
16	3	500-8020-0	BSCS 8-32 x 1.25 SS

APPROVALS	DATE	Universal Laser Systems, Inc.	
W. GORHAM	08-28-04	TITLE	
CHECKED	SERVICE	XL TOP DOOR ASSY	
ENGINEERING	PRODUCTION	A	
P R O P R I E T A R Y N O T E		SIZE	REV
THIS DRAWING AND ANY DATA DISCLOSED THEREIN IS THE PROPERTY OF UNIVERSAL LASER SYSTEMS, INC. AND CONSTITUTES AND CONTAINS PROPRIETARY AND CONFIDENTIAL INFORMATION. NEITHER RECEIPT NOR POSSESSION OF THIS DRAWING CONVEYS OR TRANSFERS ANY RIGHT TO DUPLICATE, USE, OR DISCLOSE ANY INFORMATION CONTAINED HEREIN EXCEPT AS EXPRESSLY AUTHORIZED BY UNIVERSAL LASER SYSTEMS, INC.		B	-
		DRAWING NO. 131-0071 (0072)-0	DO NOT SCALE DRAWING